

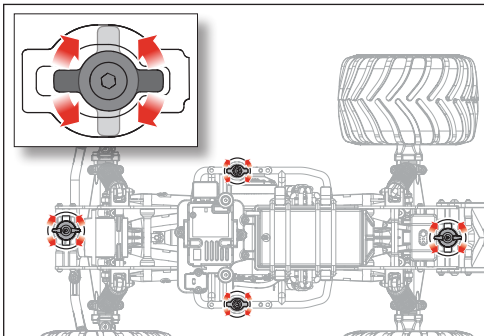

# QUICKSTART GUIDE



### 1. Remove the Body



### 2. Remove the Vehicle Battery

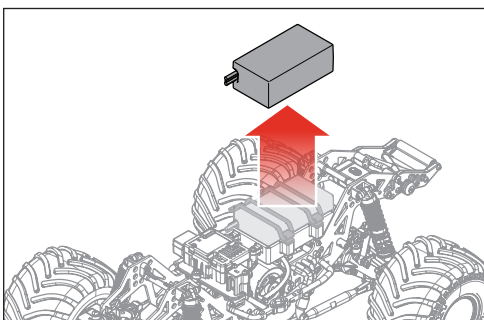

### 3. Charge the Vehicle Battery

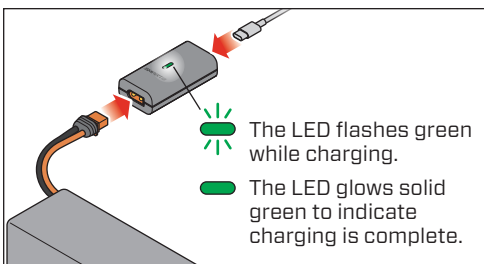

### 4. Reinstall the Vehicle Battery

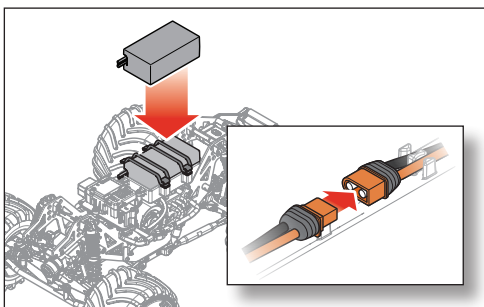

### 5. Install the Transmitter Batteries

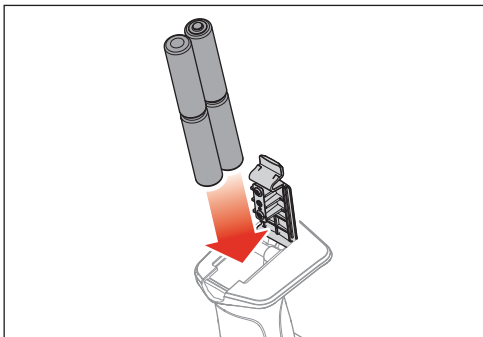

### 6. Power On the Transmitter

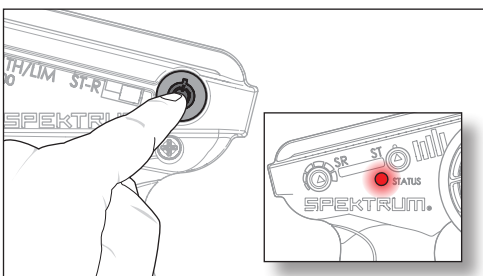

### 7. Power On the Vehicle

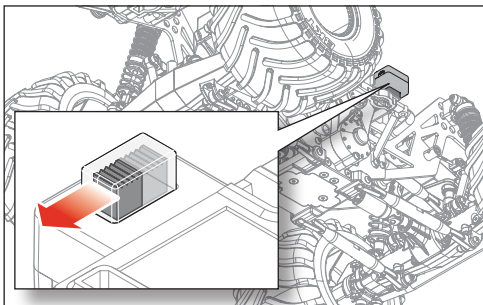

### 8. Reinstall the Body

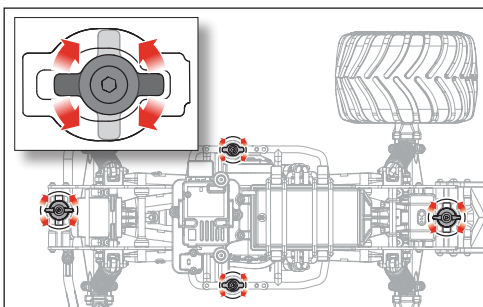

## 9. Throttle/Brake

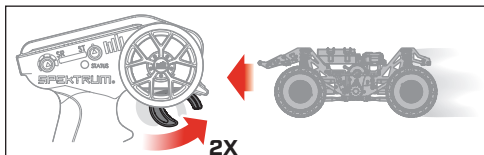
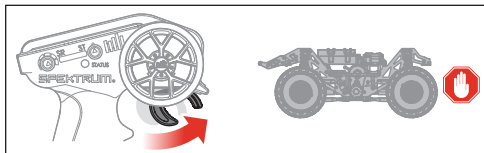
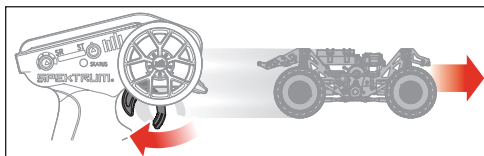

## 10. Steering

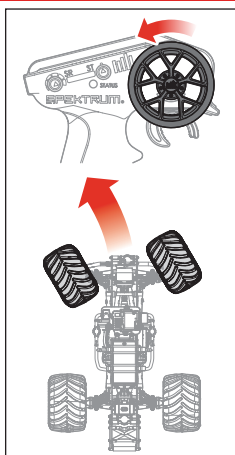
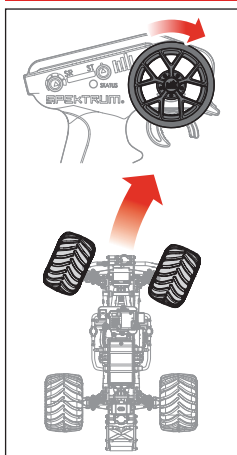

## 11. Throttle Limiter

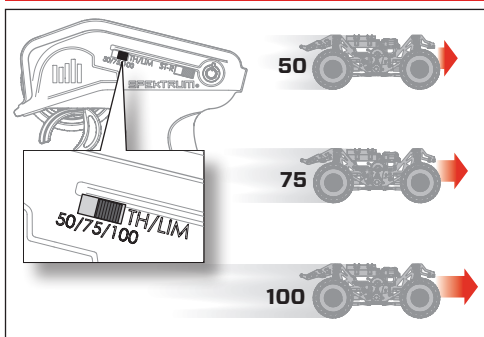

## 12. Steering Rate

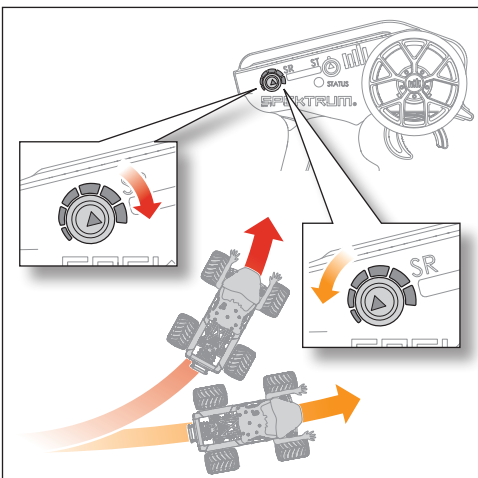

## 13. Steering Trim

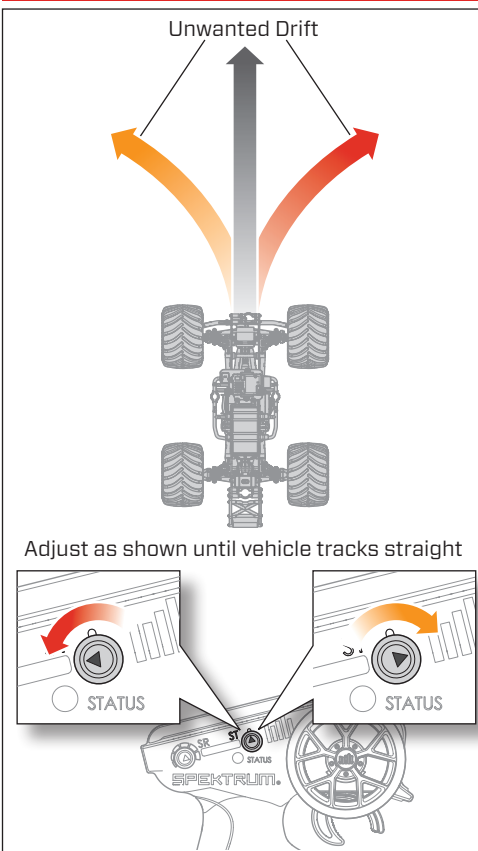

#### 14. Remove the Body

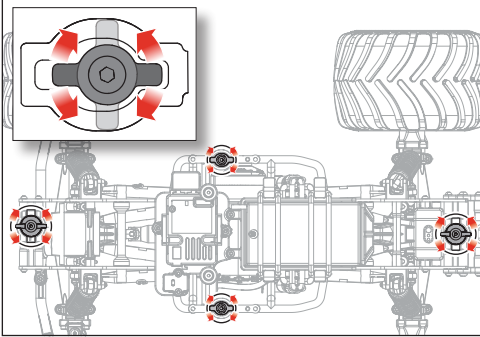

#### 16. Disconnect the Vehicle Battery

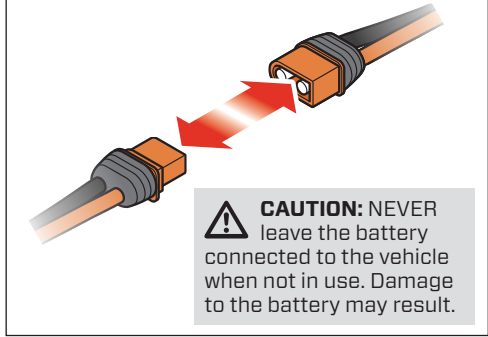

#### 15. Power Off the Vehicle

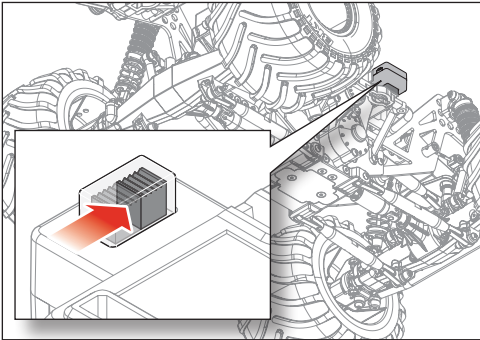

#### 17. Power Off the Transmitter

