

# MP15AC

## NOTICE

All instructions, warranties and other collateral documents are subject to change at the sole discretion of Horizon Hobby, LLC. For up-to-date product literature, visit [athearn.com](http://athearn.com) and click on the support tab for this product.

## Meaning of Special Language

The following terms are used throughout the product literature to indicate various levels of potential harm when operating this product:

**NOTICE:** Procedures, which if not properly followed, create a possibility of physical property damage AND a little or no possibility of injury.

**WARNING:** Procedures, which if not properly followed, create the probability of property damage, collateral damage, and serious injury OR create a high probability of superficial injury.

**⚠ WARNING:** Read the ENTIRE instruction manual to become familiar with the features of the product before operating. Failure to operate the product correctly can result in damage to the product, personal property and cause serious injury. This is a sophisticated hobby product. It must be operated with caution and common sense and requires some basic mechanical ability. Failure to operate this Product in a safe and responsible manner could result in injury or damage to the product or other property. This product is not intended for use by children without direct adult supervision. Do not attempt disassembly, use with incompatible components or augment product in any way without the approval of Horizon Hobby, LLC. This manual contains instructions for safety, operation and maintenance. It is essential to read and follow all the instructions and warnings in the manual, prior to assembly, setup or use, in order to operate correctly and avoid damage or serious injury.

**Age Recommendation: Not for Children under 14 years. This is not a toy.**

**PLEASE NOTE:**  
**PARTS VARY BY CAR AND/OR ROADNAME**  
**AND ARE SUBJECT TO AVAILABILITY.**



Thank you for purchasing your new Athearn® Genesis® HO scale model. Painstaking attention to detail has been taken to make your model "As Close to Real as it Gets™" while providing a superior drive and full-feature electronics for reliable prototypical operations.

Blending these features together provides a platform that should meet and exceed the most discriminating modeler's preferences.

Sincerely,  
The Athearn Team

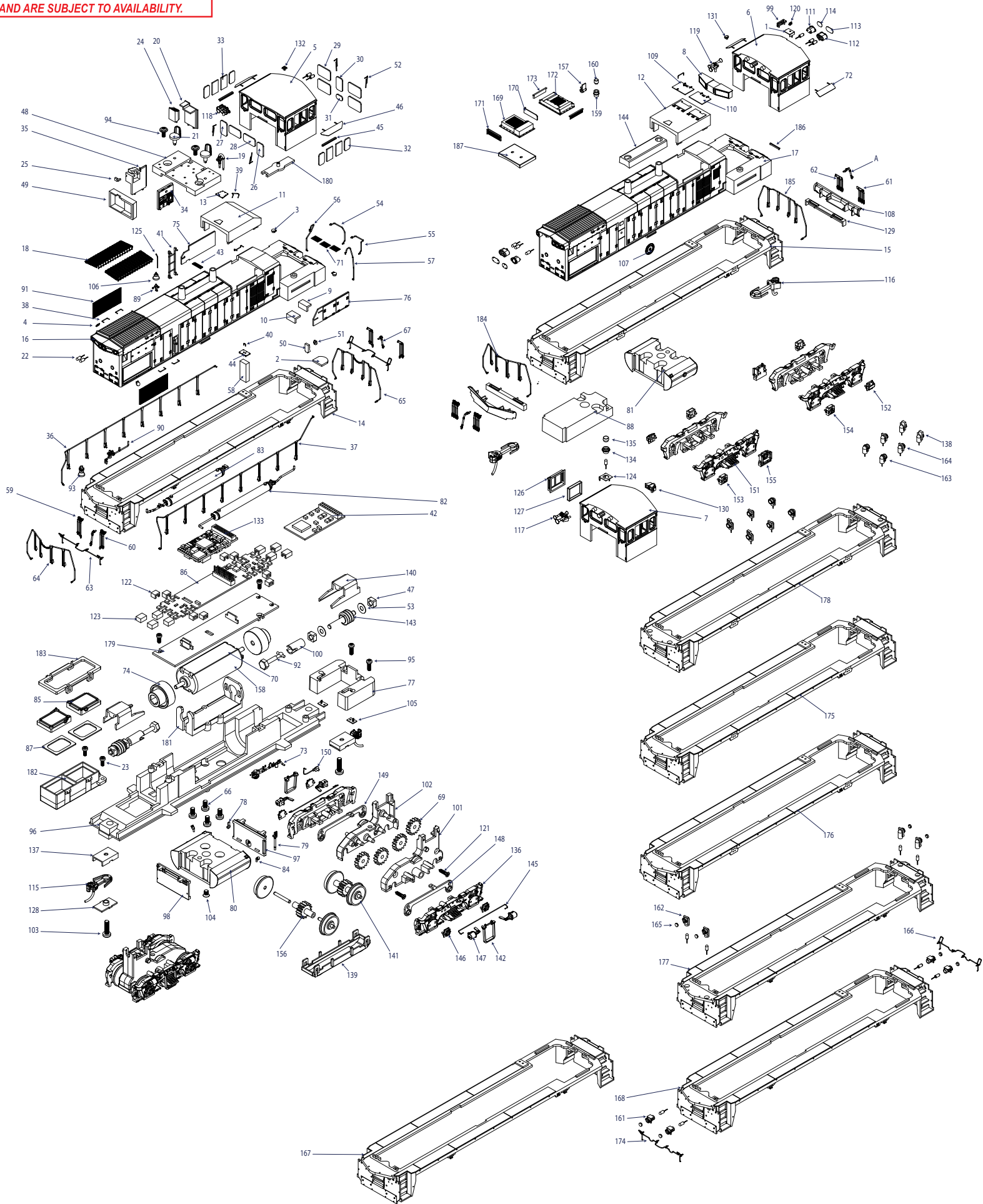

# MP15AC

1	90618.012	- WSOR EOT Antenna Bracket	98	G66012.03	- Tank Plate, Rear
2	G6601	- Rear Drop Step	99	91586.3	- Antenna, Sinclair, Large
3	G66024	- Sand Filler Lid, Rear	100	G62381	- Female Coupling
4	G66023	- Sand Filler Lid, Front	101	G62384	- Gear Box, Female
5	G66002	- Cab, MP15 AC, Standard	102	G62383	- Gear Box, Male
6	G66003	- Cab, MP15 AC, SP	103	99004	- Screw, PM2D1X9 HD4
7	G66003.1	- Cab, Ex-SP w/ Single Headlight	104	99038	- Screw, KM2X3 HD3D4
8	39003	- Number Board Housing, SP	105	99202.09	- ASM PCB Truck Light
9	G66026	- Cab Step, V1	106	G66037.01	- Bell
10	G66027	- Cab Step, V2	107	G66019	- Brake Wheel
11	G66017	- Air Filter Box, Angled	108	G66039	- Snow Plow
12	G66016	- Air Filter Box, Square	109	G66029.01	- Air Filter Access Door, Right
13	G66028	- Air Filler Box Inspetion Plate	110	G66029.02	- Air Filter Access Door, Left
14	G66004	- Walkway, Standard	111	91588	- Single Gyalright Housing
15	G66005	- Walkway, SP	112	G66034	- Twin Gyalright Housing
16	G66000	- Bodyshell, Standard	113	G66042.08	- Twin Gyalright Cover
17	G66001	- Bodyshell, SP	114	G66042.07	- Single Gyalright Cover
18	G66042.02	- Roof Grill	115	90615	- ASM Coupler, McHenry
19	G66031.07	- Cab Interior Pipe	116	90605	- AASM Coupler, Long
20	G66031.04	- Central Cabinet Rear	117	90614.1192	- Horn, Leslie S-3L-R on Cab Face Bracket
21	G66031.09	- Seat Style, V1	118	90614.2032	- Horn, Nathan K5LA, All Forward
22	65900	- LED Bulb	119	90614.2033	- Horn, Nathan P-3
23	99040	- Screw, PM1D8X3D5 HD3	120	91586.4	- Antenna, Sinclair, Small EOT
24	G66031.06	- Instrument Panels	121	G63847	- Screw, KB1D5X6D7XHD2D7
25	G66031.08	- Speedometer	122	G63838.02	- Wire Clip, 2
26	G66041.01	- Window Glass, Cab Front, Door	123	G63838.03	- Wire Clip, 3
27	G66041.02	- Window Glass, Cab Front, Vertical	124	G66042.06	- Bracket, Stratolite
28	G66041.03	- Window Glass, Cab Front, Center	125	G66014.04	- Airline, Bell
29	G66041.04	- Window Glass, Cab Rear	126	G68221.01	- All-Weather Window Frame, 2 Pane
30	G66041.05	- Window Glass, Cab Rear, Door Top	127	G68221.02	- All-Weather Window Glass, 2 Pane
31	G66041.06	- Window Glass, Cab Rear, Door Bottom	128	80519.01	- Coupler Box Cover, RTR
32	G66041.07	- Window Glass, Cab Side, Outer	129	91649	- MU Hose Catch Box
33	G66041.08	- Window Glass, Cab Side, Middle	130	90618.337	- Electronic Bell
34	G66031.03	- Central Cabinet, Left	131	91645.03	- Vent, Round
35	G66031.05	- Central Cabinet, Right	132	91586.7	- Whip Antenna, Square Base
36	G66045.04	- Long Handrail, Right	133	99202.10	- 21Pin Decoder, Sound
37	G66045.03	- Long Handrail, Left	134	G40371.01	- Prime 8911 Stratolite Beacon, Base
38	G66014.01	- Grabiron, Straight	135	G40371.02	- Prime 8911 Stratolite Beacon, Dome
39	G66014.02	- Grabiron, Drop	136	G62370	- Sideframe, Blomberg-B
40	G66014.03	- Grabiron, Box Ld	137	80519.02	- Coupler Box, RTR
41	G66020	- Ladder Side	138	G14273.02	- Ditch Light, Deck Mount, V4
42	G90580.21	- 21Pin Decoder, Non-sound	139	G62385	- Bottom Clip
43	G66042.05	- Stepguard Step, Right	140	G62382	- Worm Housing
44	G66025.02	- ECAFB Lid	141	19254	- ASM Wheel Unit
45	G66038	- Armrest	142	G62375	- Spring Hanger, Blomberg-B
46	47648	- Sunshade	143	40063	- Brass Worm And Shaft
47	G40052	- Bearing	144	G66018	- Exhaust Muffler
48	G66031.01	- Interior, Cab Floor	145	G68231	- Air-line, Blomberg-B
49	G66031.02	- Front Cabinet	146	G62371	- Bearing Cap, Hyatt
50	G66022.01	- MU Box Rear	147	G62376	- Brake Cylinder, Blomberg-B
51	G66022.02	- MU Box Lid	148	G62388	- Metal Truck Sideplate, Left
52	G66042.03	- Windshield Wiper	149	G62389	- Metal Truck Sideplate, Right
53	G62021	- Thrust Washer	150	90614.0006	- Speed Recorder
54	G66045.08	- Cab Entry Railing, Right	151	G62972	- Sideframe, Blomberg-B, No Brake
55	G66045.07	- Cab Entry Railing, Left	152	G62372	- Bearing Cap, Sloped
56	G66045.06	- Stepwell Railing, Right Rear	153	G62373	- Bearing Cap, Square
57	G66045.05	- Stepwell Railing, Left Rear	154	G62374	- Bearing Cap, Square, SP/RC
58	G66025.01	- ECAFB Box	155	G62377	- Bearing, Hyatt w/ ATS Shoe
59	G67034.01	- Signal Hoses, Left, V1	156	G62386	- Axle Gear, 15T
60	G67034.02	- Signal Hoses, Right, V1	157	G62378	- ATC Pickup, Sidesill Mount
61	G66050.02	- Signal Hoses, Right, for Snowplow	158	G99511.01	- Motor 1443
62	G66050.01	- Signal Hoses, Left, for Snowplow	159	G68289.01	- Saturn 6552 Xenon Strobe Base
63	G66040	- Uncoupler Lever	160	G68289.02	- Saturn 6552 Xenon Dome
64	G66045.01	- End Handrail, Front	161	G68251.01	- Dltchlight, Pilot Mounted
65	G66045.02	- End Handrail, Rear	162	G14271.01	- Ditchlight, Deck Mount, Square With Angled Bracket
66	99001	- Screw, PM2D1XH4D2 HD4	163	G14272.01	- Ditchlight, Deck Mount, Round Top
67	G66036	- Air Pipe Hose, V1	164	G14273.01	- Ditchlight, Deck Mount, Square
68	G66035	- Air Pipe Hose, V2	165	G68251.02	- Lens, Pilot Mounted Ditchlight
69	G62387	- Idler Gear 16T	166	G14275	- Uncoupler Lever, Ditchlight, Pilot, Rear
70	G62017.1	- ASM Motor MP15 AC	167	G14276	- Walkway, Standard, Ditchlight, Deck, Front/Rear
71	G66042.04	- Step, Rear Entry	168	G14277	- Walkway, Pilot Mount, Ditchlight, Both Ends
72	90618.043	- FNM Sunshade	169	91592.01	- Air Conditioner, Vapor, Body
73	G66032	- Air Filter and Pipe, Large	170	91592.02	- Air Conditioner, Vapor, Side Plate, Left
74	G99511.02	- Motor Fywheel 1443	171	91592.03	- Air Conditioner, Vapor, Side Plate, Right
75	G66015.01	- Battery Box, Right	172	G63454.01	- Air Conditioner, Prime
76	G66015.02	- Battery Box, Left	173	G63454.02	- Air Conditioner, Prime, Side Plate
77	G66011	- C Shape Weight	174	G66051	- Uncoupler Lever, Ditchlight, Pilot, Front
78	G66012.05	- Sight Glass,Right	175	G16004	- Walkway, SP, Ditchlight, Pilot
79	G66012.04	- Sight Glass, Left	176	G16003	- Walkway, SP, Ditchlight, Pilot Rear
80	G66013.01	- Fuel Tank, 1600 Gal	177	G66004.02	- Walkway, Standard, Ditchlight, Deck
81	G66012.01	- Fuel Tank, 1100 Gal	178	G66005.02	- Walkway, SP, Ditchlight, Deck
82	G66030.01	- Air Tank, Right	179	99202.01	- Adapter Board Bracket
83	G66030.02	- Air Tank, Left	180	99202.02	- Cab Light Wire Cover
84	G66012.06	- Fuel Filler	181	99202.03	- Motor Mount 1443
85	90464.01	- Speaker, Square	182	99202.04	- Speaker, Housing, Square
86	67140.01	- Mother Board	183	99202.05	- Speaker Square, Housing Cover
87	90465.01	- Speaker Gasket, Square	184	99202.06	- End Handrai, Front, V2
88	G66009	- Weight, Front	185	99202.07	- End Handrail, Rear, V2
89	G66037.02	- Bracket, Bell	186	99202.08	- Tread _lug
90	G66033	- Small, Air Filter and Pipe	187	G63827	- Air Conditioner Base
91	G66042.01	- Intake Grill			
92	99516	- Drive Shaft, D551 Inch			
93	91791	- Bell, Underframe			
94	99039	- Screw, PWB1D7X4 HD4D2			
95	99036	- Screw, PM1D7X5 HD3			
96	G66008	- Chassis, MP15 AC			
97	G66012.02	- Tank Plate, Front			